





Feilden Fowles

It is no understatement to say it has been an extraordinary couple of years for Feilden Fowles. As well as picking up a clutch of highly prized jobs, the 11-year-old practice's blossoming reputation was bolstered further when it made the 2019 RIBA Stirling Prize shortlist with its Yorkshire Sculpture Park visitor centre.

Set up by Fergus Feilden, 38, and Edmund Fowles, 36, the company now boasts 21 staff, all of whom are under 40. Despite its growth, the practice has held onto the low-tech, low-impact, environmentally focused design principles showcased in its very first project, Ty Pren, a Welsh passive longhouse clad in local larch and slate (2009).

The tone-setting 'exceedingly green' home in the Brecon Beacons was followed by a number of schools and, in 2018, the construction of the practice's own home, a demountable timber office and neighbouring barn at Waterloo City Farm. However, a series of significant contest wins has catapulted them to a new level. Their victory in the competition for a new dining hall at Homerton College, Cambridge, saw them beat 154 rival

Top The RIBA Stirling Prize-shortlisted Yorkshire Sculpture Park Weston visitor centre

Opposite Feilden Fowles' own studio and Waterloo City Farm phasing diagram

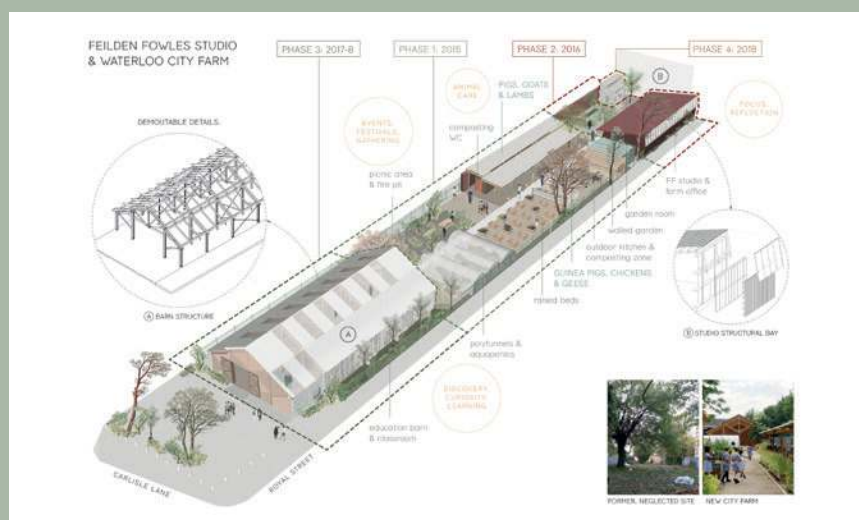

bids and a shortlist which included dRMM, Caruso St John and Walters & Cohen. Earlier this year the firm was chosen ahead of Carmody Groarke, 6a architects and Heneghan Peng Architects to land the new £16.5 million entrance hall project at York's The National Railway Museum.

Many firms previously looking over their shoulder at Feilden Fowles may now find themselves trailing in the wake of the ambitious outfit, which looks set to become – in its own words – ‘one of Britain’s leading practices’. *RW*

TOP: PETER COOK

Milestones

- 2005** Practice co-founders Fergus Feilden and Edmund Fowles complete their Part 1s at Cambridge University
- 2009** Feilden Fowles Architects is officially set up. The duo completes Ty Pren – ‘House of Wood’ in Welsh – in the Brecon Beacons
- 2012** Wraps taken off the £1.75 million Lee Centre on the Ralph Allen School campus in Bath, which is built from cross-laminated timber
- 2017** Picked ahead of star-studded shortlist for £8.2 million dining hall for Homerton College, Cambridge
- 2018** Creates own timber studio and barn at Waterloo City Farm as part of phased development of the site
- 2019** Makes RIBA Stirling Prize shortlist with its Weston visitor centre and gallery at the Yorkshire Sculpture Park
- 2020** Completes Fraternity at Carlisle Cathedral. Wins contest for new £16.5 million entrance hall at York's National Railway Museum. Wins permission to rework the grounds of the Natural History Museum